

**Болт Vira с цилиндрична глава вътрешен шестостен  
неръждаем M12x90 мм, 7.0, A2, 1.75 мм, DIN 912**



# DIN 912 - sim. ISO 4762

Viti testa cilindrica esagono incassato

Hexagon socket head cap screws

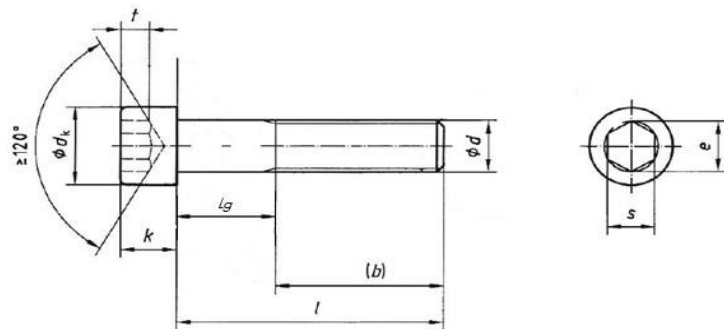

disponibile in A2 / A4  
available in A2 / A4



| d  | M1,6 | M2   | M2,5 | M3   | M4   | M5   | M6    | M8   | M10   | M12   | (M14)  | M16    | (M18)  | M20    | M24   | M30    |        |
|----|------|------|------|------|------|------|-------|------|-------|-------|--------|--------|--------|--------|-------|--------|--------|
| b* | 15   | 16   | 17   | 18   | 20   | 22   | 24    | 28   | 32    | 36    | 40     | 44     | 48     | 52     | 60    | 72     |        |
| dk | max. | 3    | 3,8  | 4,5  | 5,5  | 7    | 8,5   | 10   | 13    | 16    | 18     | 21     | 24     | 27     | 30    | 36     | 45     |
|    | min. | 2,86 | 3,62 | 4,32 | 5,32 | 6,78 | 8,28  | 9,78 | 12,73 | 15,73 | 17,73  | 20,67  | 23,67  | 26,67  | 29,67 | 35,61  | 44,61  |
| e  | min. | 1,73 | 1,73 | 2,3  | 2,87 | 3,44 | 4,58  | 5,72 | 6,86  | 9,15  | 11,43  | 13,72  | 16     | 16     | 19,44 | 21,73  | 25,15  |
| k  | max. | 1,6  | 2    | 2,5  | 3    | 4    | 5     | 6    | 8     | 10    | 12     | 14     | 16     | 18     | 20    | 24     | 30     |
|    | min. | 1,46 | 1,86 | 2,36 | 2,86 | 3,82 | 4,82  | 5,7  | 7,64  | 9,64  | 11,57  | 13,57  | 15,57  | 17,57  | 19,48 | 21,48  | 29,48  |
| s  | max. | 1,56 | 1,56 | 2,06 | 2,58 | 3,08 | 4,095 | 5,14 | 6,14  | 8,175 | 10,175 | 12,212 | 14,212 | 14,212 | 17,23 | 19,275 | 22,275 |
|    | min. | 1,52 | 1,52 | 2,02 | 2,52 | 3,02 | 4,02  | 5,02 | 6,02  | 8,025 | 10,025 | 12,032 | 14,032 | 14,032 | 17,05 | 19,065 | 22,065 |
| t  | min. | 0,7  | 1    | 1,1  | 1,3  | 2    | 2,5   | 3    | 4     | 5     | 6      | 7      | 8      | 9      | 10    | 12     | 15,5   |
| P  | 0,35 | 0,4  | 0,45 | 0,5  | 0,7  | 0,8  | 1     | 1,25 | 1,5   | 1,75  | 2      | 2      | 2,5    | 2,5    | 3     | 3,5    |        |

\* valido solo per le misure disponibili con filetto parziale (vedi tabella seguente)

\*Only valid for sizes available in partial thread (see table)

La dimensioni tra parentesi sono sconsigliate

The size in brackets should be avoided if possible

last edit 26/09/2019 pag.1/3

DRAWING N. 1067

| d    | M1,6   | M2   | M2,5   | M3   | M4   | M5   | M6   | M8   | M10   | M12   | (M14) | M16   | (M18) | M20   | M24   | M30 |
|------|--------|------|--------|------|------|------|------|------|-------|-------|-------|-------|-------|-------|-------|-----|
| 3    | 1,6x3  | 2x3  | /      | /    | /    | /    | /    | /    | /     | /     | /     | /     | /     | /     | /     | /   |
| 4    | 1,6x4  | 2x4  | 2,5x4  | 3x4  | /    | /    | /    | /    | /     | /     | /     | /     | /     | /     | /     | /   |
| 5    | 1,6x5  | 2x5  | 2,5x5  | 3x5  | 4x5  | /    | /    | /    | /     | /     | /     | /     | /     | /     | /     | /   |
| 6    | 1,6x6  | 2x6  | 2,5x6  | 3x6  | 4x6  | 5x6  | 6x6  | /    | /     | /     | /     | /     | /     | /     | /     | /   |
| 8    | 1,6x8  | 2x8  | 2,5x8  | 3x8  | 4x8  | 5x8  | 6x8  | 8x8  | /     | /     | /     | /     | /     | /     | /     | /   |
| 10   | 1,6x10 | 2x10 | 2,5x10 | 3x10 | 4x10 | 5x10 | 6x10 | 8x10 | /     | /     | /     | /     | /     | /     | /     | /   |
| 12   | 1,6x12 | 2x12 | 2,5x12 | 3x12 | 4x12 | 5x12 | 6x12 | 8x12 | 10x12 | /     | /     | /     | /     | /     | /     | /   |
| 14** | /      | 2x14 | 2,5x14 | 3x14 | 4x14 | 5x14 | 6x14 | 8x14 | /     | /     | /     | /     | /     | /     | /     | /   |
| 16   | 1,6x16 | 2x16 | 2,5x16 | 3x16 | 4x16 | 5x16 | 6x16 | 8x16 | 10x16 | 12x16 | /     | /     | /     | /     | /     | /   |
| 18** | /      | /    | /      | 3x18 | 4x18 | 5x18 | 6x18 | 8x18 | 10x18 | /     | /     | /     | /     | /     | /     | /   |
| 20   | /      | 2x20 | 2,5x20 | 3x20 | 4x20 | 5x20 | 6x20 | 8x20 | 10x20 | 12x20 | 14x20 | 16x20 | /     | /     | /     | /   |
| 22** | /      | /    | /      | 3x22 | 4x22 | 5x22 | 6x22 | 8x22 | 10x22 | /     | /     | /     | /     | /     | /     | /   |
| 25   | /      | /    | 2,5x25 | 3x25 | 4x25 | 5x25 | 6x25 | 8x25 | 10x25 | 12x25 | 14x25 | 16x25 | /     | /     | /     | /   |
| 30   | /      | /    | /      | 3x30 | 4x30 | 5x30 | 6x30 | 8x30 | 10x30 | 12x30 | 14x30 | 16x30 | 18x30 | 20x30 | /     | /   |
| 35   | /      | /    | /      | 3x35 | 4x35 | 5x35 | 6x35 | 8x35 | 10x35 | 12x35 | 14x35 | 16x35 | 18x35 | 20x35 | /     | /   |
| 40   | /      | /    | /      | 3x40 | 4x40 | 5x40 | 6x40 | 8x40 | 10x40 | 12x40 | 14x40 | 16x40 | 18x40 | 20x40 | 24x40 | /   |
| 45   | /      | /    | /      | 3x45 | 4x45 | 5x45 | 6x45 | 8x45 | 10x45 | 12x45 | 14x45 | 16x45 | 18x45 | 20x45 | 24x45 | /   |
| 50   | /      | /    | /      | 3x50 | 4x50 | 5x50 | 6x50 | 8x50 | 10x50 | 12x50 | 14x50 | 16x50 | 18x50 | 20x50 | 24x50 | /   |

\*\* Lunghezze non previste dalla norma DIN e da considerarsi similar

These measures aren't DIN standard but you can consider them similar DIN

Per le misure al di sopra della linea tratteggiata: lg max= 3 P

Per le lunghezze al di sotto della linea tratteggiata: lg max = l - b

For screws with lengths above the dashed line, the maximum distance between the last fully formed thread and the bearing face: lg max = 3 P

For lengths below the line, lg are be calculated used the followin equation: lg max = l - b

Le lunghezze standard sono quelle tra le due linee in grassetto.

The range of commercial lengths i between the bold stepped lines.

last edit 26/09/2019 pag.2/3

DRAWING N. 1067

Продукт: [Болт Віра с цилиндрична глава вътрешен шестостен неръждаем M12x90 мм, 7.0, A2, 1.75 мм, DIN 912](#)

Категория: [Болтове и винтове метрична резба](#)

Бранд: [Віра](#)

Категория бранд: [Болт Віра](#)